

The *Northwynd 2*

POST & BEAM



Inspired by the popularity of Northwynd 1 home design, this home kit offers a slightly larger footprint and one extra bathroom.

Square Footage

| | |
|---------------------------|------------|
| MAIN FLOOR | 875 |
| UPPER FLOOR | 0 |
| UNFINISHED/ BONUS AREA | 0 |
| TOTAL LIVING AREA | 875 |
| GARAGE | 0 |
| COVERED ENTRY/PORCH | 0 |
| BALCONY/ DECK | 0 |
| TOTAL AREA | 875 |

Dimensions

| | |
|-------|-------|
| WIDTH | DEPTH |
| 42 | 25 |

Designs, Images & Plans © Linwood Homes Ltd.

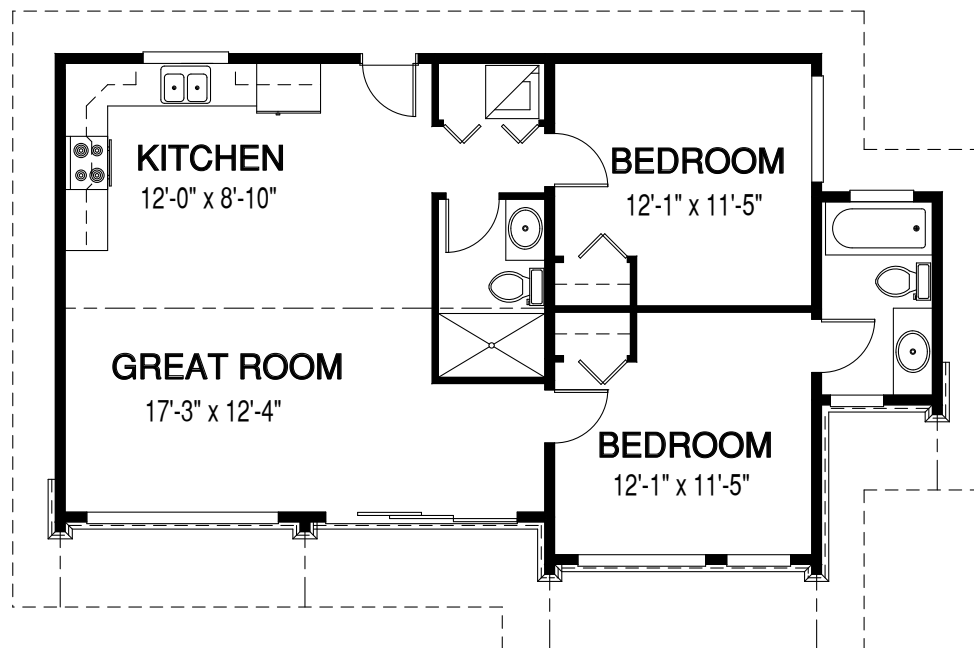

MAIN FLOOR



Contact us today for a price quote or details: linwoodhomes.com/ask • 1-888-546-9663

POST & BEAM: The Post & Beam Home Package includes full custom concept design, construction plans, technical support, and all the materials required to build the structure of your home to the lock-up stage.