

# The *Clearwater*

**POST & BEAM**



## Square Footage

|                           |             |
|---------------------------|-------------|
| MAIN FLOOR                | 1628        |
| UPPER FLOOR               | 880         |
| UNFINISHED/<br>BONUS AREA | 0           |
| <b>TOTAL LIVING AREA</b>  | <b>2508</b> |
| GARAGE                    | 663         |
| COVERED ENTRY/PORCH       | 38          |
| BALCONY/<br>DECK          | 0           |
| <b>TOTAL AREA</b>         | <b>3209</b> |

## Dimensions

|       |       |
|-------|-------|
| WIDTH | DEPTH |
| 56    | 62    |

The Clearwater post and beam home design drew inspiration from the timeless component of natural wood. This custom home kit has lasting appeal.

Designs, Images & Plans © Linwood Homes Ltd.

### MAIN FLOOR

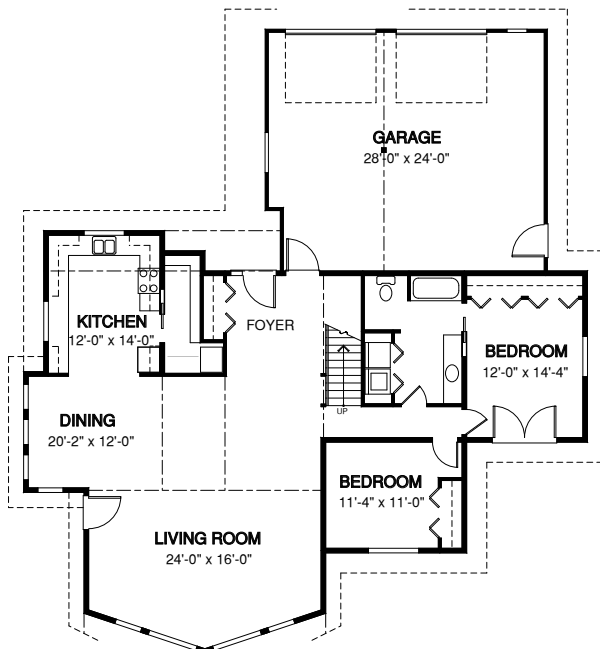

### UPPER FLOOR

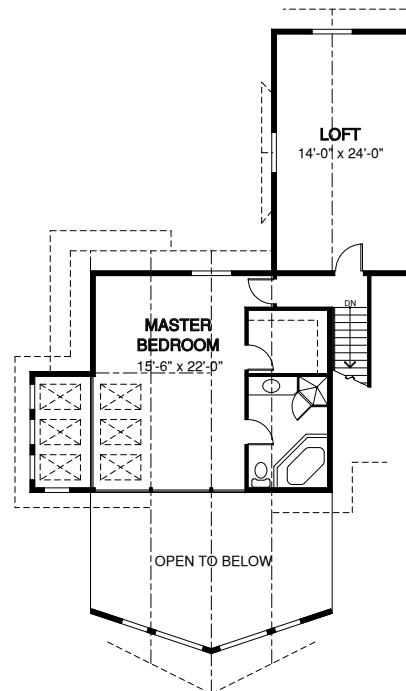

Contact us today for a price quote or details: [linwoodhomes.com/ask](https://linwoodhomes.com/ask) • 1-888-546-9663

**POST & BEAM:** The Post & Beam Home Package includes full custom concept design, construction plans, technical support, and all the materials required to build the structure of your home to the lock-up stage.