

The Chesapeake

POST & BEAM



Square Footage

MAIN FLOOR	1891
UPPER FLOOR	752
UNFINISHED/ BONUS AREA	0
TOTAL LIVING AREA	2643
GARAGE	0
COVERED ENTRY/PORCH	0
BALCONY/ DECK	48
TOTAL AREA	2691

Dimensions

WIDTH	DEPTH
60	41

The Chesapeake post and beam home design is spectacular. As Linwood's flagship model home in Delta, BC, visitors are invited to take a closer look.

Designs, Images & Plans © Linwood Homes Ltd.

MAIN FLOOR

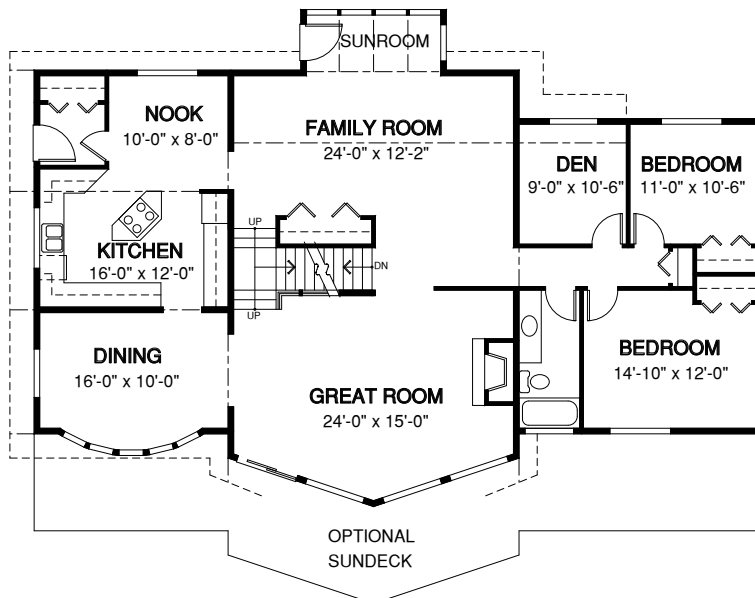

UPPER FLOOR

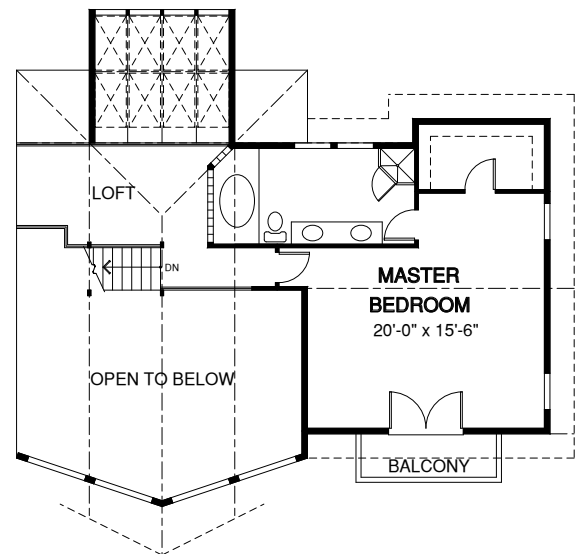

Contact us today for a price quote or details: linwoodhomes.com/ask • 1-888-546-9663

POST & BEAM: The Post & Beam Home Package includes full custom concept design, construction plans, technical support, and all the materials required to build the structure of your home to the lock-up stage.