

# The *Manchester*

**POST & BEAM**



## Square Footage

MAIN FLOOR	1229
UPPER FLOOR	537
UNFINISHED/ BONUS AREA	1470
<b>TOTAL LIVING AREA</b>	<b>3236</b>
GARAGE	528
COVERED ENTRY/PORCH	651
BALCONY/ DECK	0
<b>TOTAL AREA</b>	<b>4415</b>

## Dimensions

WIDTH	DEPTH
63	63

This beautifully-styled post and beam home is perfect for entertaining with its open concept main floor. It features a generous master suite with two additional bedrooms and a bonus flex space on the third floor.

Designs, Images & Plans © Linwood Homes Ltd.

### LOWER FLOOR

### MAIN FLOOR

### UPPER FLOOR

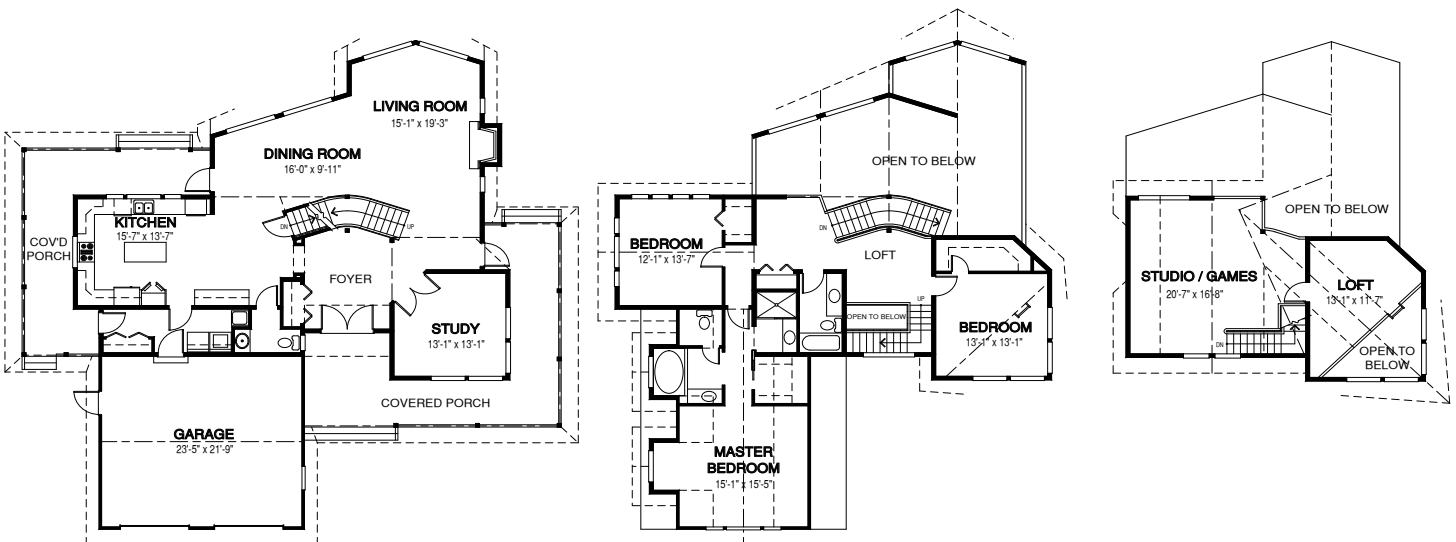

Contact us today for a price quote or details: [linwoodhomes.com/ask](https://linwoodhomes.com/ask) • 1-888-546-9663

**POST & BEAM:** The Post & Beam Home Package includes full custom concept design, construction plans, technical support, and all the materials required to build the structure of your home to the lock-up stage.