

The *Naturals 3*

POST & BEAM



Square Footage

MAIN FLOOR	1476
UPPER FLOOR	0
UNFINISHED/ BONUS AREA	0
TOTAL LIVING AREA	1476
GARAGE	0
COVERED ENTRY/PORCH	36
BALCONY/ DECK	0
TOTAL AREA	1512

Dimensions

WIDTH	DEPTH
54	34

The Naturals 3 home package expands on the same style as Naturals 2 with another modular-style building block to provide an additional 576 sq. ft. of living space.

Designs, Images & Plans © Linwood Homes Ltd.

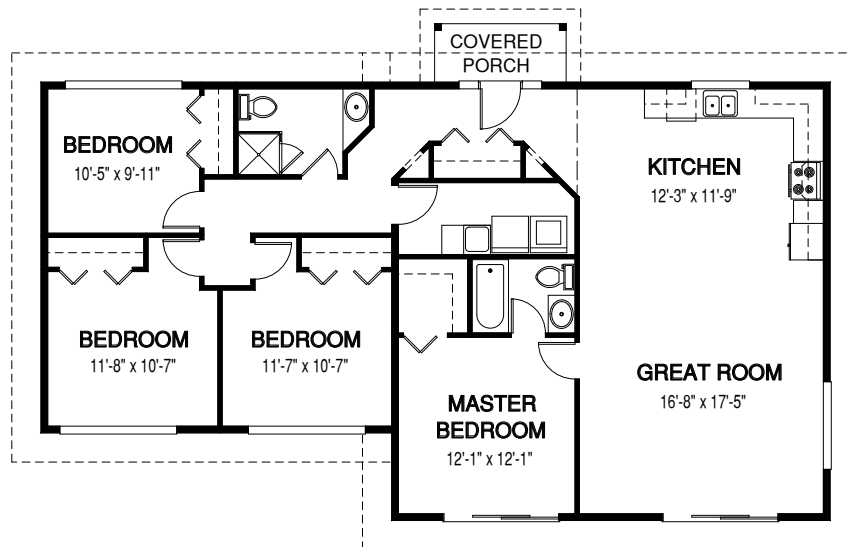

MAIN FLOOR



Contact us today for a price quote or details: linwoodhomes.com/ask • 1-888-546-9663

POST & BEAM: The Post & Beam Home Package includes full custom concept design, construction plans, technical support, and all the materials required to build the structure of your home to the lock-up stage.